

1. Begin by unpacking your canopy LED kit. Locate the two adapters in image #1 and connect them to create 4x male end connections.
2. Next connect the power brick, dimmer and extra long wire to complete the power supply portion.
3. When mounting the LED bars, make sure the female ends face inward toward the center peak pole.
4. Use the velcro straps to attach LED bars to the truss bar supports.
5. If installing only 4x LED light bars, use the velcro straps to pin the male connection at the opposite end of the LED light bars.
6. When connecting up to 8x LED light bars, connect them so that they are wrapped above the truss bars and wires are not dangling.
7. Once all LED light bars are attached to frame and connected, use the supplied zip ties to condense all the extra wiring.
8. Next, run the long wiring assembled in #2 along the truss bars and connect to the main adapter assembled in #1.
9. After completing all connections, plug power brick into power supply to test and ensure all LED light bars are working.

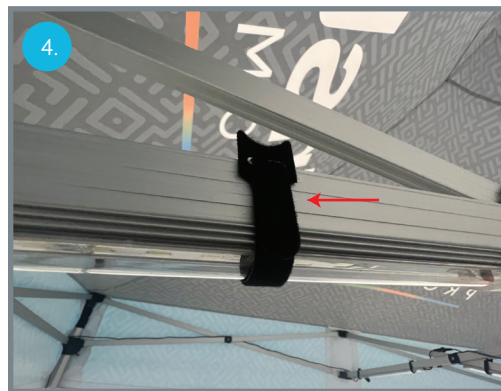

8 LED Light bar setup shown.

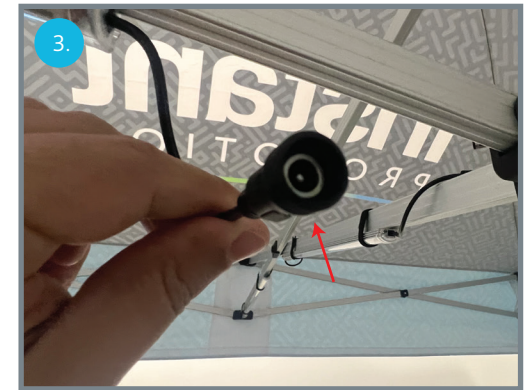
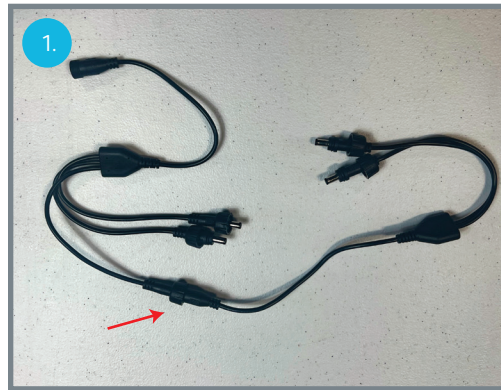